

SIEMENS

Product data sheet

3RT1035-1AP00



Abb. ähnlich / similar picture

CONTACTOR, AC-3 18.5 KW/400 V,
AC 230 V, 50 HZ, 3-POLE, SIZE S2,
SCREW CONNECTION

General details:

Size of the contactor	S2
Number of poles	3

Control circuit:

Design of activation of the operating mechanism	conventional
Type of voltage	AC
Control supply voltage	
• at 50 Hz / for AC / rated value / minimum	230 V
• at 50 Hz / for AC / rated value / maximum	230 V
Supply voltage frequency / for auxiliary and control current circuit / rated value	
• minimum	50 Hz
• maximum	50 Hz

Main circuit:

Number of NC contacts / for main contacts	0
Number of NO contacts / for main contacts	3
Operating current	
• at AC-3 / at 400 V / rated value	40 A
• at AC-1 / at 400 V / rated value	60 A

Service power	
• at AC-3 / at 400 V / rated value	18.5 kW
• at AC-1 / at 400 V / rated value	38 kW
Auxiliary circuit:	
Number of NO contacts / for auxiliary contact	0
Number of NC contacts / for auxiliary contact	0
Connection type:	
Design of the electrical connection / for main current circuit	screw-type terminals
Design of the electrical connection / for auxiliary and control current circuit	screw-type terminals
Mounting/fixing:	
Type of fixing/fixation	screw and snap-on mounting onto 35 mm standard mounting rail according to DIN EN 50022
Series installation	Yes

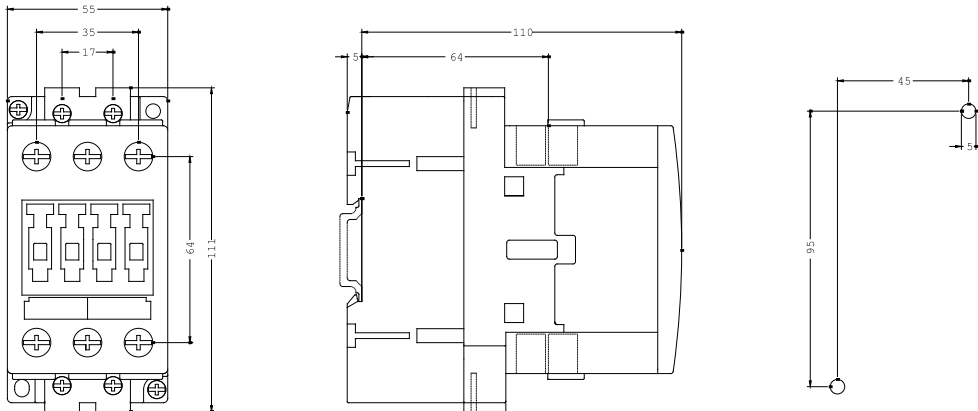

last change:

10/31/2006

Technical Assistance:	Telephone:	+49 (0) 911-895-5900 (8°° - 17°° CET)
	Fax:	+49 (0) 911-895-5907
	E-Mail:	technical-assistance@siemens.com
	Internet:	www.siemens.de/lowvoltage/technical-assistance