

# SIEMENS

## Product data sheet

## 3RT1024-1AP00



Abb. ähnlich / similar picture

CONTACTOR, AC-3 5.5 KW/400 V, AC 230 V,  
50 HZ, 3-POLE, SIZE S0, SCREW CONNECTION

### General details:

Size of the contactor	S0
Number of poles	3

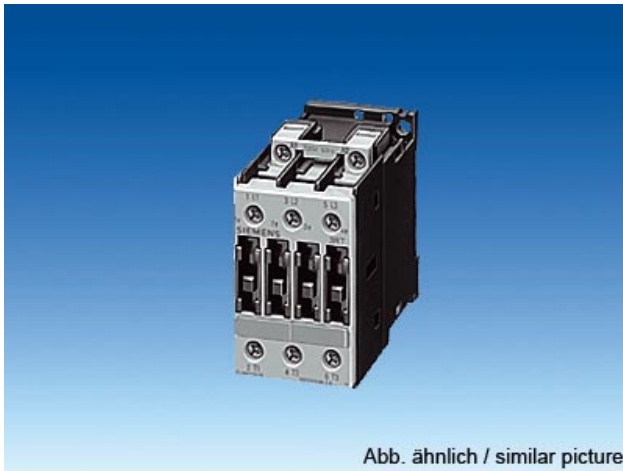
### Control circuit:

Design of activation of the operating mechanism	conventional
Type of voltage	AC
Control supply voltage	
• at 50 Hz / for AC / rated value / minimum	230 V
• at 50 Hz / for AC / rated value / maximum	230 V
Supply voltage frequency / for auxiliary and control current circuit / rated value	
• minimum	50 Hz
• maximum	50 Hz

### Main circuit:

Number of NC contacts / for main contacts	0
Number of NO contacts / for main contacts	3
Operating current	
• at AC-3 / at 400 V / rated value	12 A
• at AC-1 / at 400 V / rated value	40 A

Service power	
• at AC-3 / at 400 V / rated value	5.5 kW
• at AC-1 / at 400 V / rated value	23 kW
<b>Auxiliary circuit:</b>	
Number of NO contacts / for auxiliary contact	0
Number of NC contacts / for auxiliary contact	0
<b>Connection type:</b>	
Design of the electrical connection / for main current circuit	screw-type terminals
Design of the electrical connection / for auxiliary and control current circuit	screw-type terminals
<b>Mounting/fixing:</b>	
Type of fixing/fixation	screw and snap-on mounting onto 35 mm standard mounting rail according to DIN EN 50022
Series installation	Yes

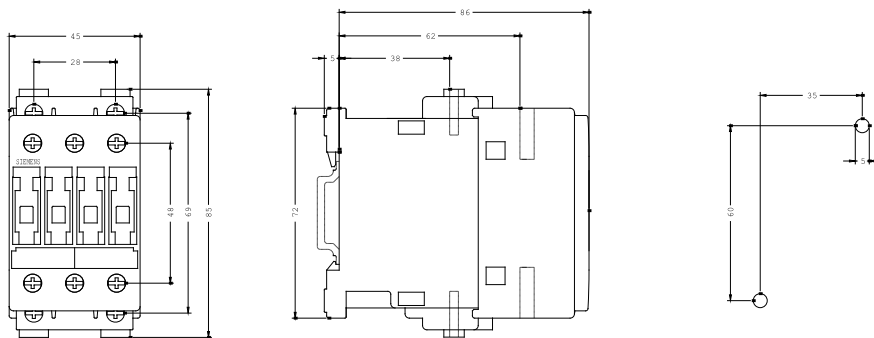

last change:

10/31/2006

<b>Technical Assistance:</b>	Telephone:	+49 (0) 911-895-5900 (8°° - 17°° CET)
	Fax:	+49 (0) 911-895-5907
	E-Mail:	technical-assistance@siemens.com
	Internet:	www.siemens.de/lowvoltage/technical-assistance